

REVISIONS

EO	REV	DESCRIPTION	DATE	APPROVED
---	B	Revised & Redrawn on SolidWorks	Sal 08/19/08	D.C. 08/20/08

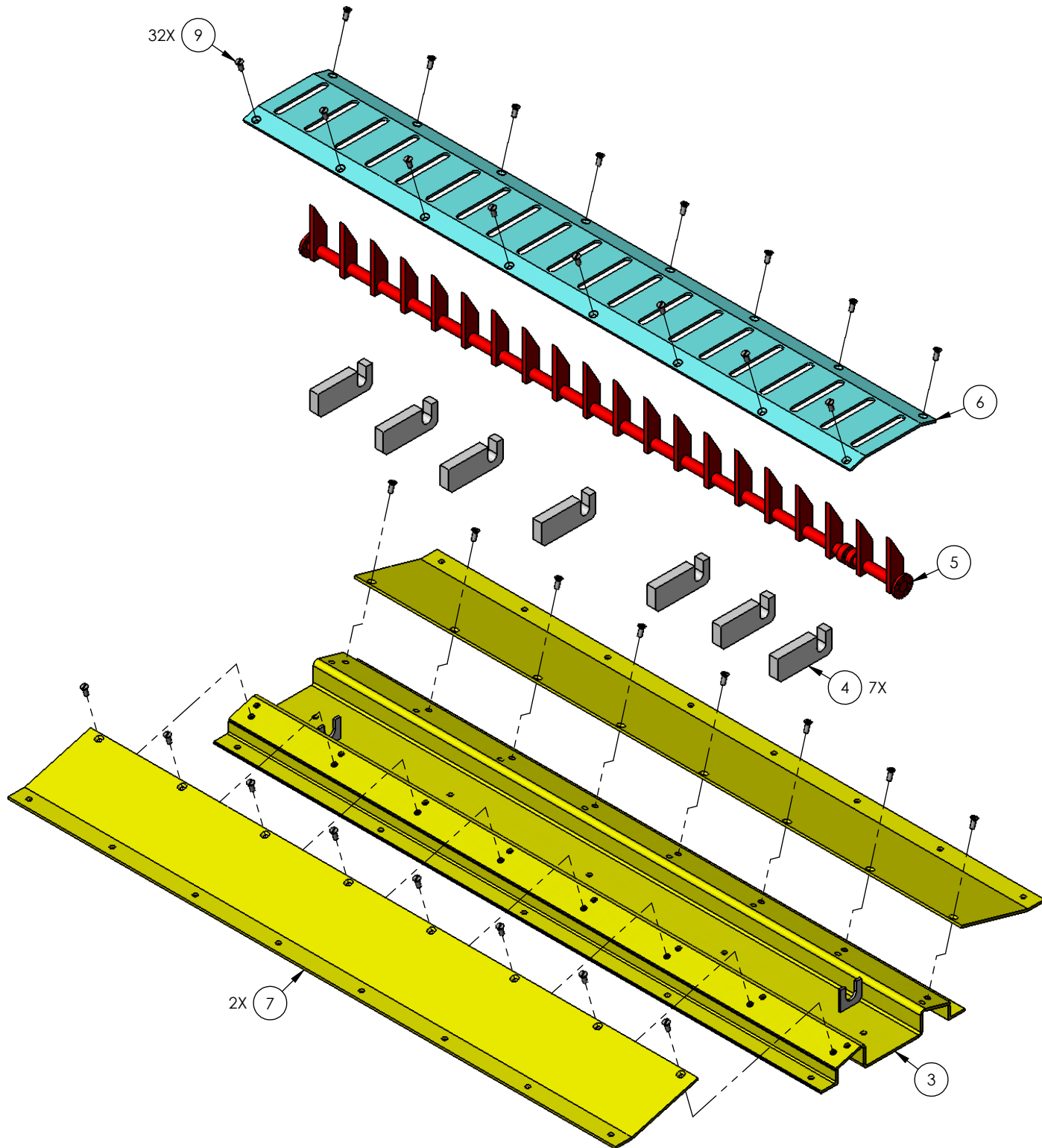

2. Items 10-12 Not Shown for Clarity.

1. See attached reference sheet for BOM;
Reference Movex 1603-076 Rev B.

Notes: Unless Otherwise Specified.

PROPRIETARY AND CONFIDENTIAL THE INFORMATION CONTAINED IN THIS DRAWING IS THE SOLE PROPERTY OF Door King. ANY REPRODUCTION IN PART OR AS A WHOLE WITHOUT THE WRITTEN PERMISSION OF Door King IS PROHIBITED.	NAME	DATE		
	DRAWN	Sal		08/20/08
	CHECKED			IPB-Model 1603-076, Parking Spike Surface Mount 6ft
	COMMENTS:			
	SIZE	DWG. NO.	REV	
	A	1603-876	B	
	Scale: None		SHEET 1 OF 2	

IPB 1603-876 Rev B
(Model and Movex No. 1603-076 Rev B)

Item	Part Number	Qty	UM	Description	List
1	1603-876	1	EA	IPB-Model 1603 Parking Spike Surface Mount 6 ft B	1.00
2	1603-100	1	EA	Spike Channel 1603	132.00
4	1603-025	7	EA	Bearing Support Block	18.00
5	1603-015	1	EA	Spike Set 70" 1603	260.00
6	1603-101	1	EA	Spike Plate Cover 1603	72.00
7	1603-102	2	EA	Spike Ramp Plate 1603	72.00
9	2615-435	32	EA	Bolt Flat Hd Hex 3/8-16 x 1 SS	8.00
10	2615-004	4	EA	Bolt Hex Head 1/4-20 1 SS	2.00
11	2620-045	4	EA	Washer Split Lock 1/4 SS	.50
12	2620-404	4	EA	Nut Hex 1/4-20 SS	1.10